

wiper A68

seal spec

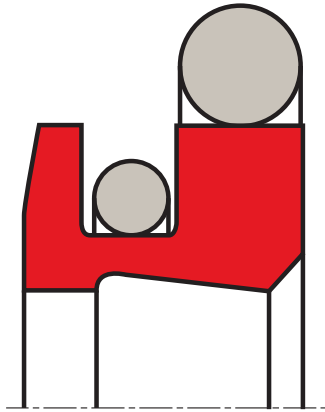

description

A68 double wiper consisting of one profile ring made from PTFE with a sealing edge and a wiper edge, as well as two O-rings as sealing and pre-load components.

application



not bolded symbols; please consult our technical for application limitations

category of profile

machined or molded/standard/trade product.

double acting

area of application: hydraulics/pneumatic

injection moulding machines, presses, mills, steel hydraulics engineering.

advantages

double wiper for improvement of total tightness. the merkel double wiper A68 is mainly fitted in combination with our rod seals S09-DS. a pressure relieving bore is to be provided between seal and wiper.

- excellent regulation and positioning in operation.
- low friction, free of stick-slip.
- material variants for short stroke and high frequency; available on enquiry.
- especially suitable for large diameters.

operating parameters & material

material		temperature	max. surface speed
sealing element	energizer		
s-mart PTFE bronze	NBR 70 shore A	-30 °C ... +100 °C	5 m/s
s-mart PTFE bronze	FKM 75 shore A	-10 °C ... +200 °C	5 m/s

the stated operation conditions represent general indications. it is recommended not to use all maximum values simultaneously. surface speed limits apply only to the presence of adequate lubrication film.

surface quality

surface roughness	Rtmax (µm)	Ra (µm)
sliding surface	according to seal data	
bottom of groove	≤6,3	≤1,6
groove face	≤15	≤3

**tolerance recommendation**

seal housing tolerances Ød (100 ... 2000)		[mm]	[mm]
ØD	H8	R	100≤.....<300
ØD1	H8	L1	300≤.....<1500
			4,2
			6,3

fitting & installation

Careful fitting is a prerequisite for the correct function of the A68. Generally, wipers can be quickly and easily fitted by deforming into a kidney shape. For diameters from >100 mm to 150 mm, a fitting tool is required. Under 100 mm, no fitting in plunge-cut groove is possible.

seal & housing recommendations

Please note that we are able to produce those profiles to your specific need or any non standard housing. For detail measurements, please see seal-mart catalog...

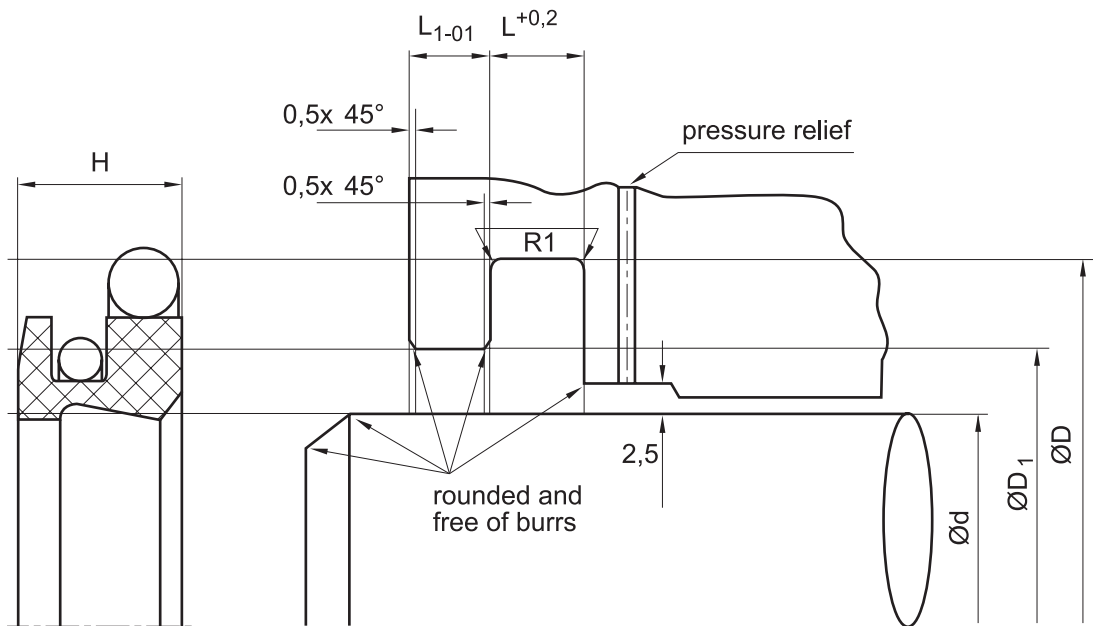

Don't hesitate to contact our technical department for further information or for special requirements (temperature, speed etc.), so that suitable materials and/or designs can be recommended.